

Diaphragm Replacement for “400” and “500” Series Guzzler Pumps

- 1) Remove pump handle or actuator by removing the two nuts on the end of the screws at the center of your pump and at the top of the clamp ring; push or pull out the screws and plastic spacers.
- 2) Next remove the clamp ring from the pump body by removing the 12 screws and nuts around the clamp ring.
Note: These include 2 short screws (without nuts) that are screwed into brass inserts in the pump body.
- 3) Remove the diaphragm assembly from the center of the pump and turn it over to reveal a 1/4x20x1/2” truss head screw. Unscrew this screw to remove the plastic button from the diaphragm. Discard the old diaphragm and reattach the plastic button to the new diaphragm using the truss head screw. Tighten the truss head screw.
Note: Be sure to note which side of the old diaphragm the plastic button was attached. (One side of the diaphragm has a lip at the edge. This lip sits into a groove in the pump body.) Attach the plastic button to the same side of the new diaphragm.
- 4) Replace the diaphragm assembly back into the pump body, being sure to seat the diaphragm lip into the groove on the circumference of the pump body. Position the clamp ring onto the pump body and replace the twelve screws and and ten nuts into the body.
Note: Remember to put the 2 shorter screws back into the brass inserts.
- 5) Replace the handle or actuator back onto the pump body, replacing the plastic pins, screws and nuts.

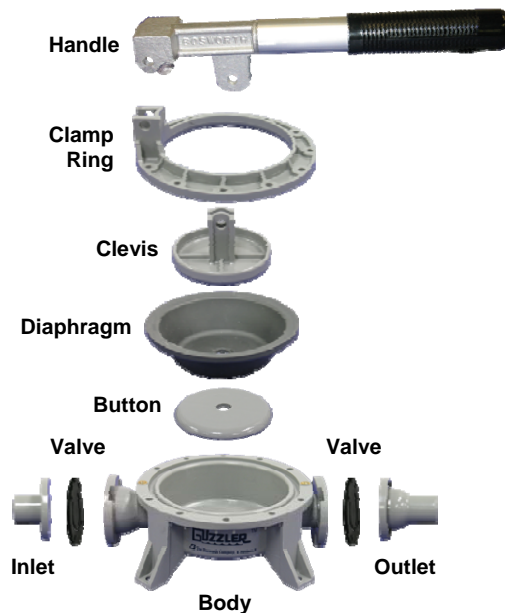

Question

“How do I replace the diaphragm on my “400” or “500” series Guzzler pump?”



Lip on diaphragm fits into groove on pump body.

