



## Guzzler® Hand Pump GH-3500A

- Rugged all-aluminum and stainless steel components
- Ideal for pumping heavy, viscous fluids
- Accommodates 1/2" - 1-1/2" hose
- 14 GPM
- Optional clamp ring with stop brackets prevents pump over-stroking
- Optional 18-inch handle employs unique guided-stroke clamp ring to reduce pumping effort by half

### Specifications / Options

<b>Body &amp; Ports *</b>	Aluminum (Black)
<b>Clamp Ring</b>	Aluminum (Black); Alum w/Stop Brackets; with Stroke Guide (Silver)
<b>Handle</b>	Aluminum: Horizontal (Black), Vertical/Silver (Removable) 18in.
<b>Valves *</b>	Flapper, Duckbill, Umbrella**
<b>Diaphragm *</b>	Buna-N, Buna-N Double Sided, Neoprene, Viton, EPDM, Silicone
<b>Clevis/Button Assembly</b>	Polypropylene; Stainless Steel Buttons* & Clevis; SS Buttons* & Aluminum Clevis
<b>Other</b>	Aluminum mounting standoffs

\* In contact with fluid

\*\* Natural Delrin umbrella valve stop

### Optional Clamp Rings



Clamp ring with stop brackets prevents over-stroking of pump handle.



Guided-stroke clamp ring ensures straight up-and-down diaphragm travel. Eliminates diaphragm rocking back-and-forth motion that contributes to diaphragm wear. Ensures maximum handle force goes into pressurizing the diaphragm.

### Performance

<b>Flow Rate</b>	Per minute <sup>1</sup> : 14 Gal (53.0L) Per stroke: 0.62 Qt (0.59L)
<b>Max Lift</b>	12 ft (3.7 m) 22 ft (6.7 m) with check valve
<b>Max Head</b>	30 ft (9.1 m)
<b>Max Pressure<sup>2</sup></b>	15 psi (1.0 kg/cm <sup>2</sup> )
<b>Max Service Temp</b>	190°F (88°C)

<sup>1</sup>: at 90 cpm

<sup>2</sup>: 20 psi with 18 in handle

### Available Ports

	in	1/2	3/4	1	1-1/4	1-1/2
	cm	1.27	1.91	2.54	3.18	3.81
<b>Hose (Smooth)</b>				•	•	S
<b>NPT Female (Tapped)</b>		•	•	•		
<b>NPT Male (Threaded)</b>			•	•		

S Standard • Optional

### Valve Options



**Flapper** — General purpose liquid transfer.



**Duckbill** — For dirty liquid and sewage. Permits mounting in any position.



**Umbrella** — Best vacuum service. Permits mounting in any position.

### Optional 18 in. Handle



18-inch aluminum handle with Alum. Stroke Guide & Guided Stroke Clevis Assembly for effortless pumping



18-inch removable vertical handle



Shown with optional mounting standoffs for ease of installation

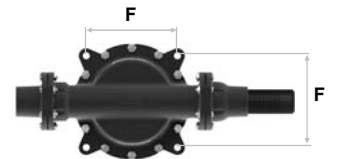
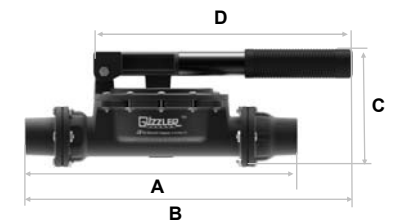

	in	cm
<b>A</b>	12-1/4	31.1
<b>B</b>	14	35.6
<b>C</b>	6-7/8	17.5
<b>D</b>	10-5/8	27.0
<b>E</b>	14-3/4	37.5
<b>F</b>	4-3/8	11.1
<b>Mounting Holes</b>	1/4	0.64
<b>Bolt Circle Diam.</b>	6-3/16	15.7
<b>Weight</b>	4.40 lb	1.99 kg

# Guzzler® Hand Pump GH-3500A



**Example: GH-3500A-211-31-8080-00**

- Guzzler Hand Pump
- Model style #3500A: Aluminum Body, Opposite Side Ports
- Horizontal Handle (Black)
- Buna-N Flapper Valves
- Buna Diaphragm
- Stainless Steel Buttons and Clevis
- Epoxy-coated Aluminum Clamp Ring
- Inlet: 1-1/2" Smooth
- Outlet: 1-1/2" Smooth
- No Spring

Guzzler Product	
Option	Code
Hand Pump	GH

Style (Family)	
Option	Code
Aluminum, Opp. Side Ports	3500A

Handle	
Option	Code
Horizontal/Black	2
Horizontal/Silver 18in***	5
Vertical/Silver (Removable) 18in.	9

Valves	
Option	Code
Flapper (Buna-N)	1
Duckbill (Buna-N)	6
Umbrella (Silicone) *	7

Diaphragm	
Option	Code
Buna Nitrile	1
Buna-N 3-Ply	2
Neoprene	3
Viton	4
EPDM	5
Silicone	7

**GH - 3500A - 2 1 1 - 3 1 - 80 80 - 00**

Clevis/Button Assembly	
Option	Code
Polypropylene	2
SS Buttons & Clevis	3
SS Washer & Alum Clevis	4
SS Buttons & Guided-Stroke Clevis**	6

Clamp Ring	
Option	Code
Epoxy-coated Alum - Black	1
Epoxy-coated Alum with Stop Brackets	4
Epoxy-coated Alum w/Stroke Guide**	5

Hose Connections		
Option	Code	
	Inlet	Outlet
1/2" NPT Tapped	31	31
3/4" NPT Tapped	41	41
3/4" NPT Threaded	42	42
1" Smooth	50	50
1" NPT Threaded	52	52
1" NPT Tapped	51	51
1-1/4" Smooth	70	70
1-1/2" Smooth	80	80

Internal Spring	
Option	Code
No Spring	00

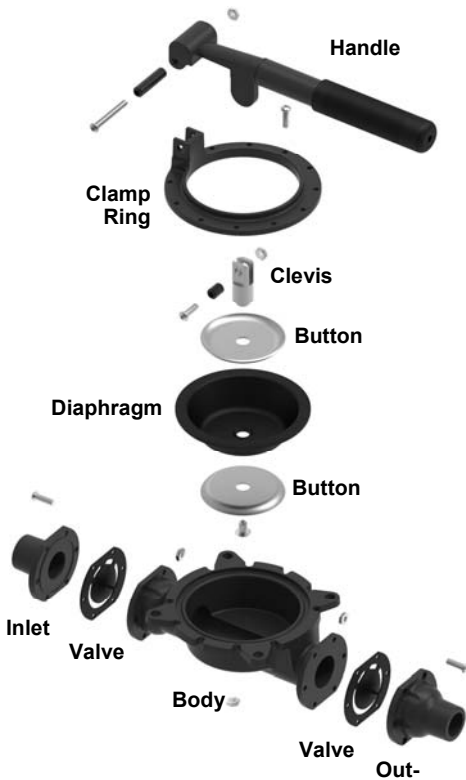

\* Umbrella valve has Acetal resin valve stops.

\*\* Clamp Ring (5) requires Clevis/Button Assembly (6)

\*\*\* 18" handle requires Clamp Ring (5) & Clevis/Button Assembly (6)